





AC1350 Wi-Fi Router

Dual Band | MU-MIMO



Archer C60

 867 Mbps 5 GHz +
450 Mbps 2.4 GHz

 Five Antennas for
Faster AC Wi-Fi

 Access Point
Mode

 Beamforming Technology
for Better Coverage

Highlights

Beamforming for Better Coverage

Five external omni-directional antennas create strong, clear, dependable Wi-Fi throughout your home. Beamforming detects the location of your connected devices and concentrates the Archer C60's signal towards them to optimize wireless connections.

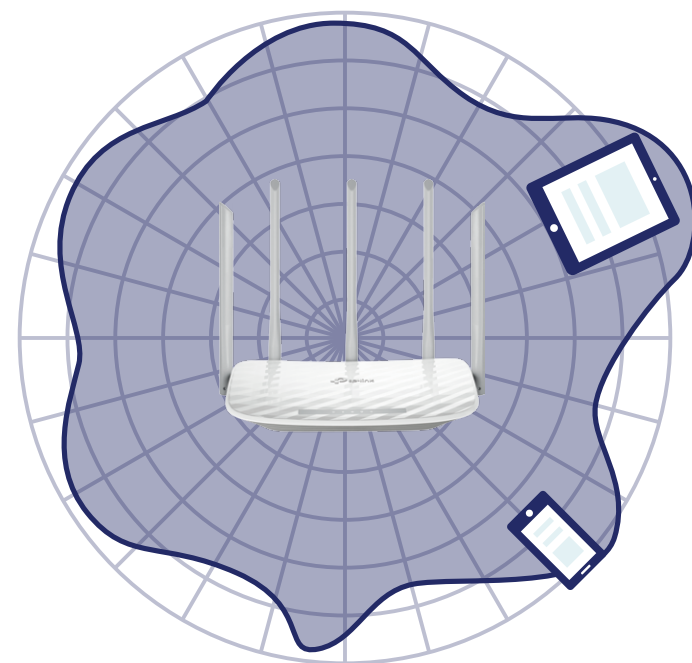

Archer C60

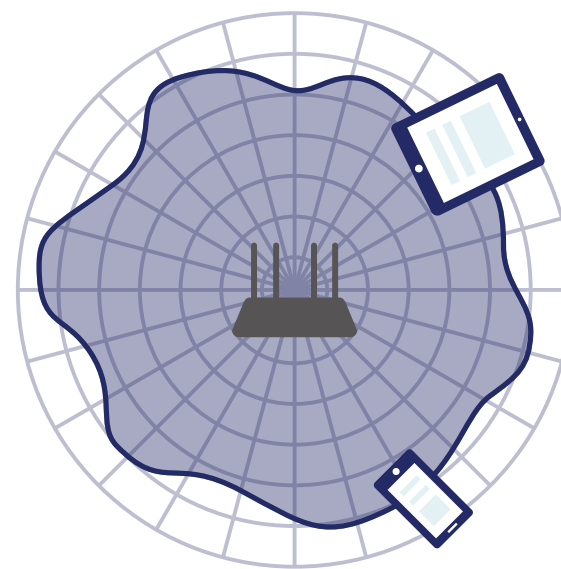

Regular Router

Fast Ethernet

Enjoy fast, reliable wired connections for gaming and streaming in the best quality.

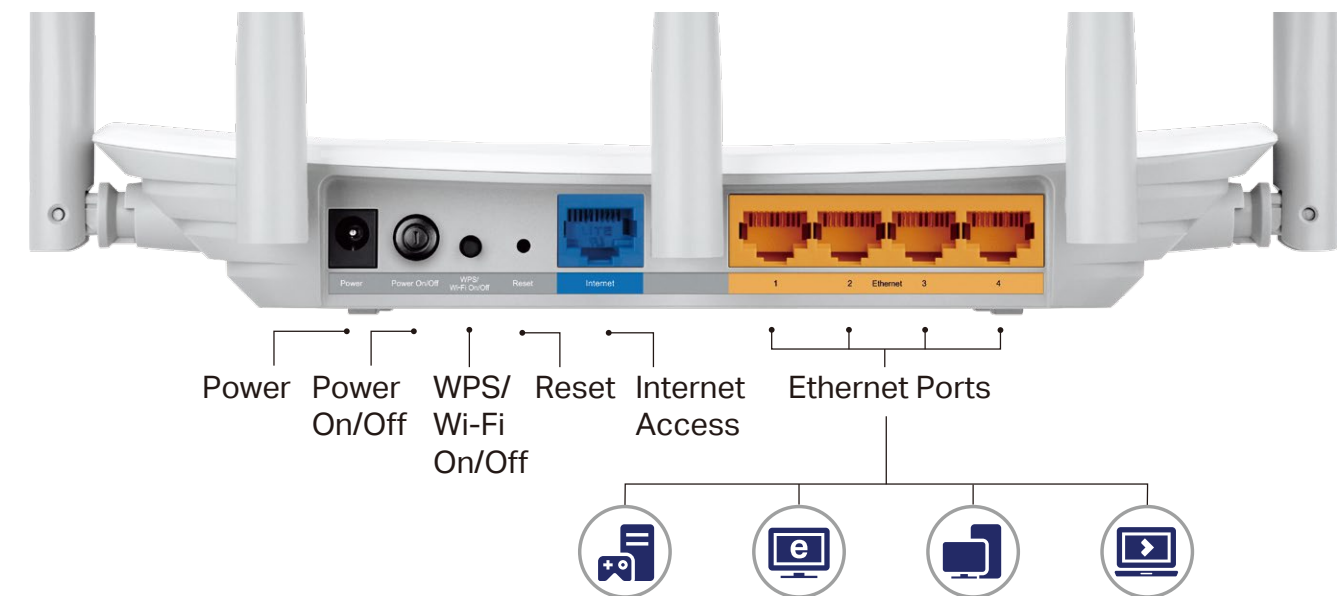

Highlights

MU-MIMO for Faster Connections

MU-MIMO technology serves multiple devices at once, reducing wait time, increasing Wi-Fi throughput for every device, and making each stream more efficient.



MU-MIMO Router
Simultaneously sends data to multiple devices

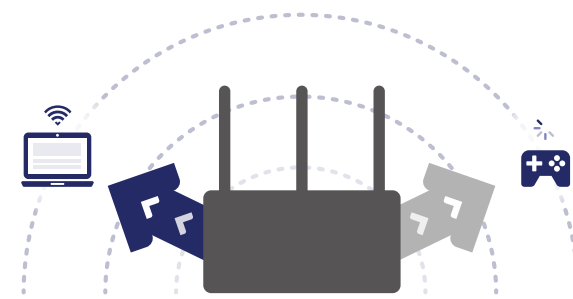

Traditional Router
Sends data to one device at a time

Speeds up to 1317 Mbps

867 Mbps on the 5 GHz band and 450 Mbps on the 2.4 GHz band are ideal for both everyday tasks and lag-free online entertainment.

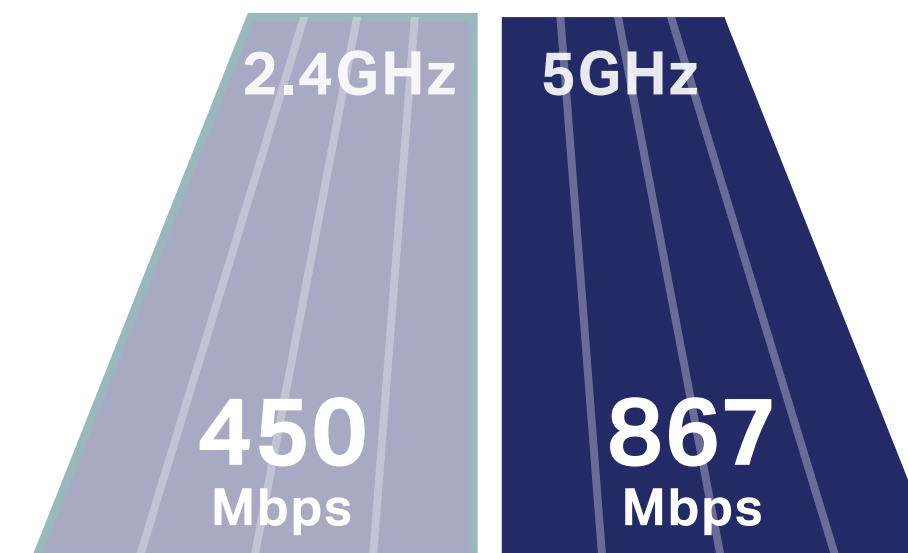

Features



Speed

- **Ultimate Wireless Speed** – Combined wireless speeds up to 450 Mbps (over 2.4GHz) and 867 Mbps (over 5GHz)
- **MU-MIMO Technology** – Simultaneously exchanges data with several devices, achieving speeds faster than standard AC routers
- **Support 802.11 ac** – Provides a data transfer rate 3 times faster than 802.11n for each stream

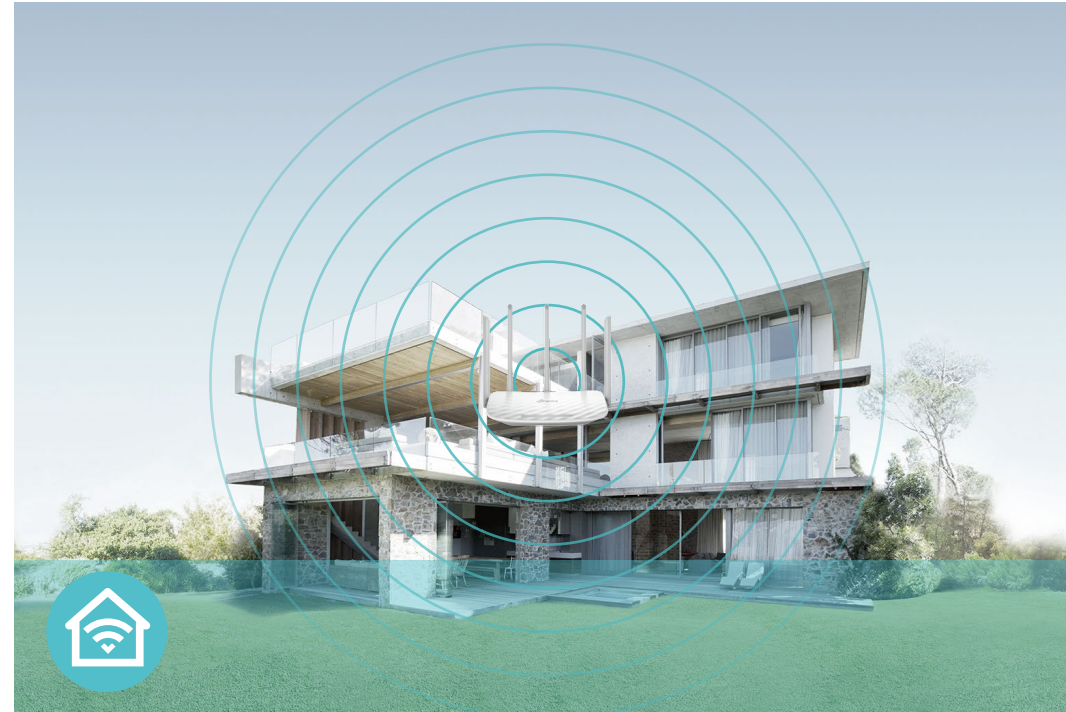

Wi-Fi Range

- **Ultimate Range Wi-Fi** – 5 high-performance antennas with a high-powered amplifier ensure the widespread Wi-Fi coverage and a stable connection
- **Wi-Fi with Beamforming** – Beamforming technology locates the connected devices and further improves the Archer C60's range and the signal strength to each mobile device, delivering a more reliable and efficient wireless connection



Reliability

- **Simultaneous Dual Band** – Separate Wi-Fi bands enable more devices to be connected to your network without a drop in performance
- **Easy Bandwidth Management** – Advanced QoS makes it easier for you to prioritize devices or applications to give faster performance where you need it
- **Access Point Mode** – Connect Wi-Fi devices to any wired network

Features

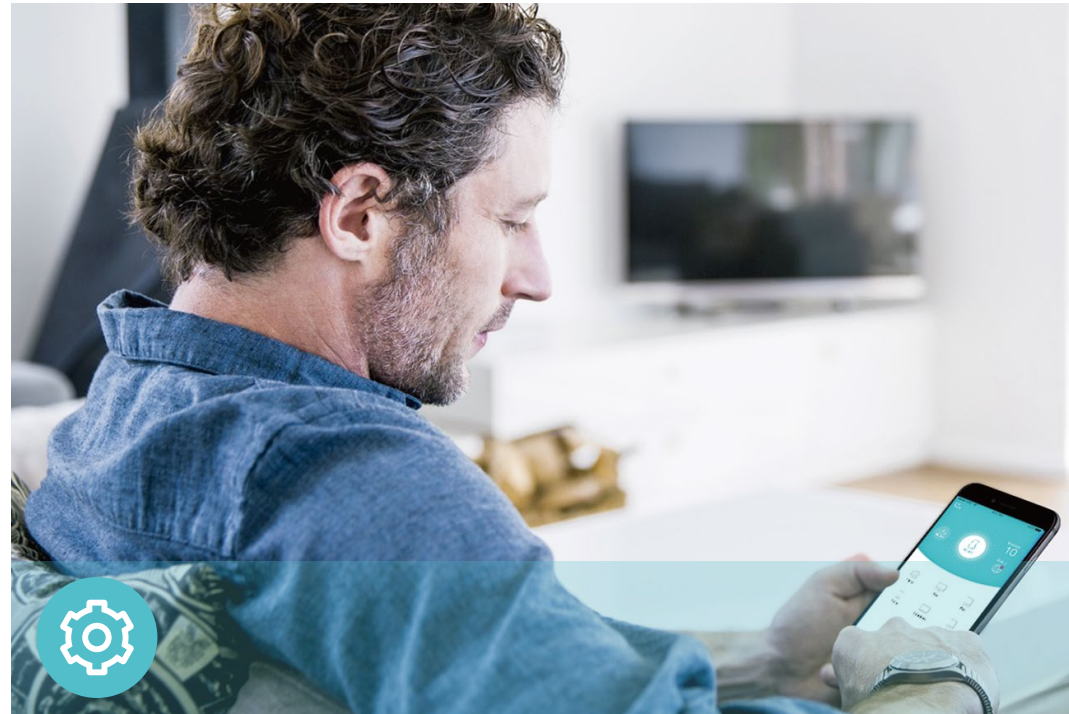

Ease of Use

- Intuitive Web UI – Ensures quick and simple Installation without hassle
- Fast Encryption – One-touch WPA wireless security encryption with the WPS button
- Wi-Fi On/Off – Turn on/off wireless radio as needed using the Wi-Fi On/Off button
- Power On/Off – Conveniently power on or off your router as required
- Hassle-free Management with Tether App – Network management is made easy with the TP-Link Tether App, available on any Android and iOS device
- Online Upgrade – Keeps you informed of the latest firmware updates, ensuring your router stays at its best



Security

- Guest Network – Keep your main network secure by creating a separate network for friends and visitors
- Access Control – Establish a whitelist or blacklist to allow or restrict certain devices to access the internet
- Parental Controls – Manage when and how connected devices can access the internet
- VPN Access – Connect to a private network with a safe and secure OpenVPN and PPTP VPN connection
- Encryptions for Secure Network – WPA-PSK and WPA2-PSK encryptions provide active protection against security threats

Specifications

Hardware

- Ethernet Ports: 4 10/100Mbps LAN Ports, 1 10/100Mbps WAN Port
- Buttons: WPS/Wi-Fi On/Off Button, Power On/Off Button, Reset Button
- Antennas: 5 Fixed Omni Directional Antennas
- External Power Supply: 12VDC/1A
- Dimensions (W x D x H): 9.1 × 5.7 × 1.4 in (230 × 144 × 37 mm)

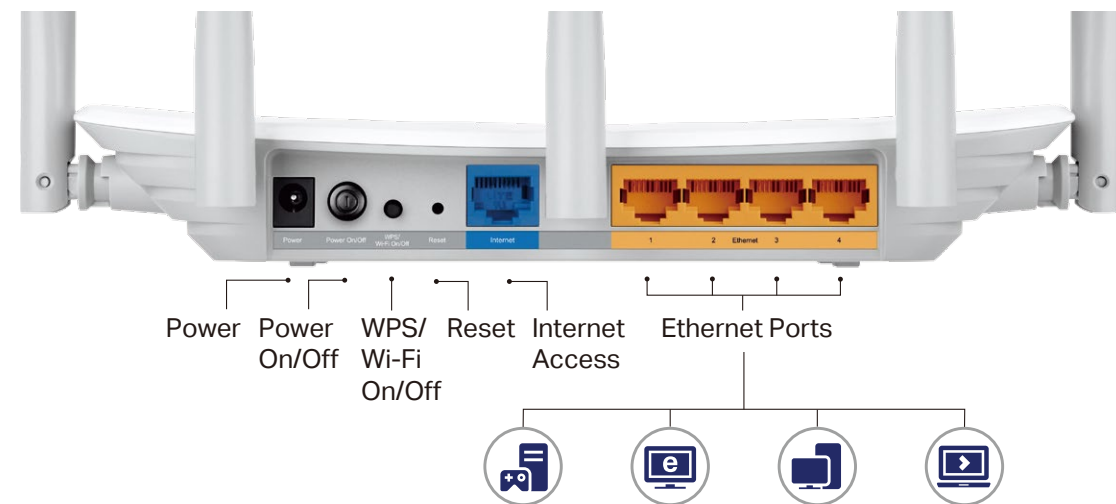

Wireless

- Wireless Standards: IEEE 802.11ac/n/a 5GHz, IEEE 802.11b/g/n 2.4GHz
- Frequency: 2.4GHz and 5GHz
- Signal Rate: 867Mbps at 5GHz, 450Mbps at 2.4GHz
- Transmit Power:
 - CE: <20dBm (2.4GHz), <23dBm (5GHz)
 - FCC: <25dBm (2.4GHz), <27dBm (5GHz)
- Reception Sensitivity:
 - 5GHz:
 - 11a 6Mbps: -94dBm, 11a 54Mbps: -78dBm
 - 11ac VHT20: -71dBm, 11ac VHT40: -66dBm, 11ac VHT80: -62dBm
 - 2.4GHz:
 - 11g 54Mbps: -78dBm, 11n HT20: -75dBm, 11n HT40: -72dBm
- Wireless Function: Enable/Disable Wireless Radio, WDS Bridge, WMM, Wireless Statistics
- Wireless Security: Enable/Disable SSID Broadcast, 64/128-bit WEP, WPA/WPA2, WPA-PSK/WPA2-PSK encryptions, QSS, Wireless MAC Filter

Specifications

Software

- Quality of Service: WMM, Bandwidth Control
- WAN Type: Dynamic IP, Static IP, PPPoE, PPTP(Dual Access), L2TP(Dual Access), Bigpond
- Management: Access Control, Local Management, Remote Management
- DHCP: Server, DHCP Client List, Address Reservation
- Port Forwarding: Virtual Server, Port Triggering, UPnP, DMZ
- Dynamic DNS: DynDns, NO-IP, TP-Link
- VPN Server: PPTP, Open VPN
- Access Control: Parental Controls, Local Management Control, Blacklist, Whitelist
- Firewall Security: DoS, SPI Firewall, IP and MAC Address Binding
- Protocols: IPv4, IPv6
- Guest Network: 2.4GHz Guest Network x 1, 5GHz Guest Network x 1

Others

- Certification:
CE, FCC, RoHS
- System Requirements:
Microsoft Windows 98SE/NT/2000/XP/Vista™/7/8/8.1/10, MAC OS, NetWare, UNIX or Linux
Internet Explorer 11, Firefox 12.0, Chrome 20.0, Safari 4.0, or other Java-enabled browser
Cable or DSL Modem
Subscription with an internet service provider (for internet access)
- Environment:
Operating Temperature: 0°C~40°C (32°F ~104°F)
Storage Temperature: -40°C~70°C (-40°F ~158°F)
Operating Humidity: 10%~90% non-condensing
Storage Humidity: 5%~90% non-condensing
- Package Contents
Wi-Fi Router Archer C60
Power Adapter
RJ45 Ethernet Cable
Quick Installation Guide



For more information, please visit

<https://www.tp-link.com/products/details/Archer-C60.html>

or scan the QR code left

Attention: This device may only be used indoors in all EU member states and EFTA countries.

Specifications are subject to change without notice. TP-Link is a registered trademark of TP-Link Technologies Co., Ltd. Other brands and product names are trademarks or registered trademarks of their respective holders. Copyright ©2019 TP-Link Technologies Co., Ltd. All rights reserved.

*Maximum wireless signal rates are the physical rates derived from IEEE Standard 802.11 specifications. Actual wireless data throughput and wireless coverage are not guaranteed and will vary as a result of network conditions, client limitations, and environmental factors, including building materials, obstacles, volume and density of traffic, and client location.

*Use of MU-MIMO requires clients to also support MU-MIMO.

www.tp-link.com

TP-Link AC1350 Wi-Fi Dual Band Router **Archer C60**